



Cabinet Door Service

PureWood™ Architectural Millwork

Arched Valance Raised 2-Panel Ordering Template

Customer # _____ Cust. Name _____

Ordered by: _____

Fax this sheet to (503) 363-6510

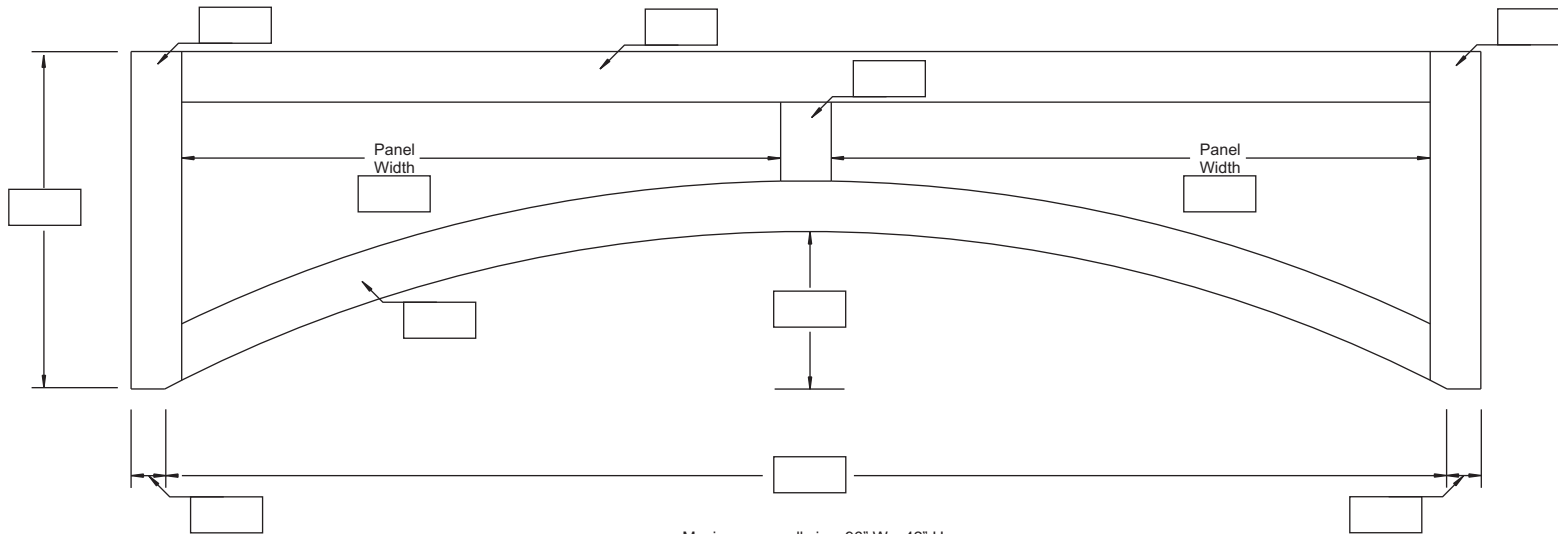

Maximum overall size: 96" W x 42" H

Panel Widths

- Equal, or
- Specified (fill in shaded area)

Due to panel expansion, recommended Panel Width with solid panels should not exceed 24".

Ordering Information

Arch Style	<input type="checkbox"/> Std Radius Arch <input type="checkbox"/> Elliptical Arch
Species	
Inside Profile <small>(See Pg. M-1.5)</small>	
Panel Profile <small>(See Pg. M-1.5)</small>	
Edge Detail <small>(See Pg. M-1.5)</small>	"E-5BB" for Square/Unsanded
Qty	
SqFt Calcs.	W _____ x H _____ /144= _____ SqFt <small>round to 1/100th SqFt</small>

Custom Frame Sizes- Price Chart

Identify the largest frame part in the configuration and enter associated multiplier into Panel Cost Calculations

Frame parts	All parts 2-1/4" Width	1.00
	From 2-3/8" to 3" Widths	1.15
	From 3-1/8" to 6" Widths	1.25
	From 6-1/8" to 12" Widths	1.35
	Over 12" Widths	1.45

Arch Panel Cost Calculations

1- Enter SqFt Pricing (from pg M-1.5)	\$
2- Custom Frame Upchg (from Chart)	1. _____
3- Adjusted SqFt Cost (Line1 x Line2)	\$
4- Total SqFt of Arch Panel	SqFt
5- Subtotal (Line3 x Line4)	\$
6- Custom Charge	\$ 310.00
7- Total Cost (Add Lines 5 & 6)	\$

Total Cost does not include Pre-finishing charges or other options.



Cabinet Door Service

PureWood™ Architectural Millwork

Arched Valance Inset 2-Panel Ordering Template

Customer # _____ Cust. Name _____

Ordered by: _____

Fax this sheet to (503) 363-6510

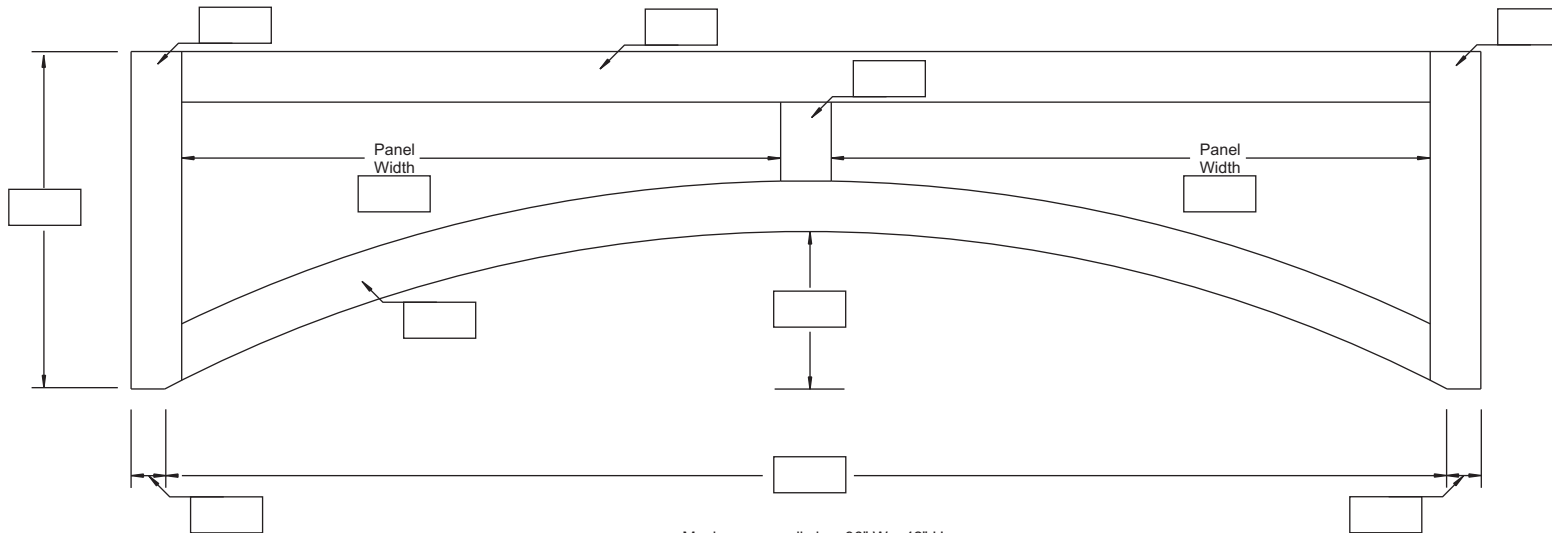

Maximum overall size: 96" W x 42" H

Panel Widths

- Equal, or
- Specified (fill in shaded area)

Due to panel expansion, recommended Panel Width with solid panels should not exceed 24".

Ordering Information

Arch Style	<input type="checkbox"/> Std Radius Arch <input type="checkbox"/> Elliptical Arch
Species	
Inside Profile <small>(See Pg. M-1.5)</small>	
Panel Profile <small>(See Pg. M-1.5)</small>	
Edge Detail <small>(See Pg. M-1.5)</small>	"E-5BB" for Square/Unsanded
Qty	
SqFt Calcs.	W _____ x H _____ /144= _____ SqFt <small>round to 1/100th SqFt</small>

Custom Frame Sizes- Price Chart

Identify the largest frame part in the configuration and enter associated multiplier into Panel Cost Calculations

Frame parts	All parts 2-1/4" Width	1.00
	From 2-3/8" to 3" Widths	1.15
	From 3-1/8" to 6" Widths	1.25
	From 6-1/8" to 12" Widths	1.35
	Over 12" Widths	1.45

Arch Panel Cost Calculations

1- Enter SqFt Pricing (from pg M-1.5)	\$
2- Custom Frame Upchg (from Chart)	1. _____
3- Adjusted SqFt Cost (Line1 x Line2)	\$
4- Total SqFt of Arch Panel	SqFt
5- Subtotal (Line3 x Line4)	\$
6- Custom Charge	\$ 260.00
7- Total Cost (Add Lines 5 & 6)	\$

Total Cost does not include Pre-finishing charges or other options.

M-5.2



Cabinet Door Service

PureWood™ Architectural Millwork

Arched Valance Raised 3-Panel Ordering Template

Customer # _____ Cust. Name _____

Ordered by: _____

Fax this sheet to (503) 363-6510

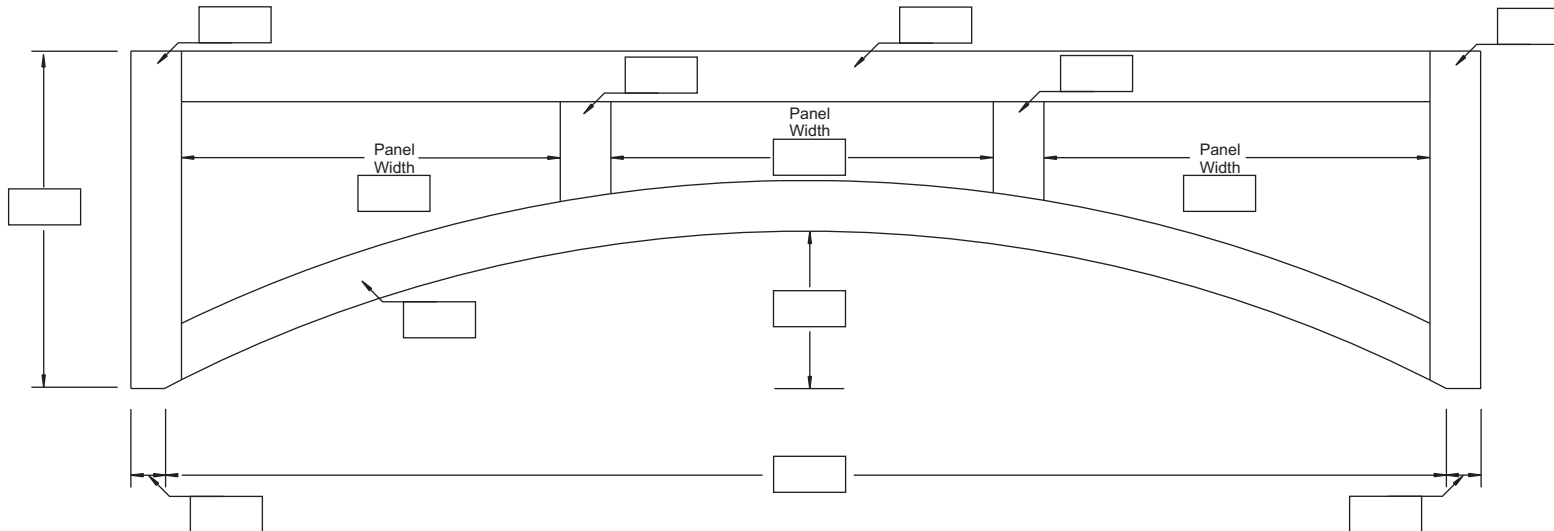

Maximum overall size: 96" W x 42" H

Panel Widths

- Equal, or
- Specified (fill in shaded area)

Due to panel expansion, recommended Panel Width with solid panels should not exceed 24".

Ordering Information

Arch Style	<input type="checkbox"/> Std Radius Arch <input type="checkbox"/> Elliptical Arch
Species	
Inside Profile <small>(See Pg. M-1.5)</small>	
Panel Profile <small>(See Pg. M-1.5)</small>	
Edge Detail <small>(See Pg. M-1.5)</small>	"E-5BB" for Square/Unsanded
Qty	
SqFt Calcs.	W _____ x H _____ /144= _____ SqFt <small>round to 1/100th SqFt</small>

Custom Frame Sizes- Price Chart

Identify the largest frame part in the configuration and enter associated multiplier into Panel Cost Calculations

Frame parts	All parts 2-1/4" Width	1.00
	From 2-3/8" to 3" Widths	1.15
	From 3-1/8" to 6" Widths	1.25
	From 6-1/8" to 12" Widths	1.35
	Over 12" Widths	1.45

Arch Panel Cost Calculations

1- Enter SqFt Pricing (from pg M-1.5)	\$
2- Custom Frame Upchg (from Chart)	1. _____
3- Adjusted SqFt Cost (Line1 x Line2)	\$
4- Total SqFt of Arch Panel	SqFt
5- Subtotal (Line3 x Line4)	\$
6- Custom Charge	\$ 465.00
7- Total Cost (Add Lines 5 & 6)	\$

Total Cost does not include Pre-finishing charges or other options.



Cabinet Door Service

PureWood™ Architectural Millwork

Arched Valance Inset 3-Panel Ordering Template

Customer # _____ Cust. Name _____

Ordered by: _____

Fax this sheet to (503) 363-6510

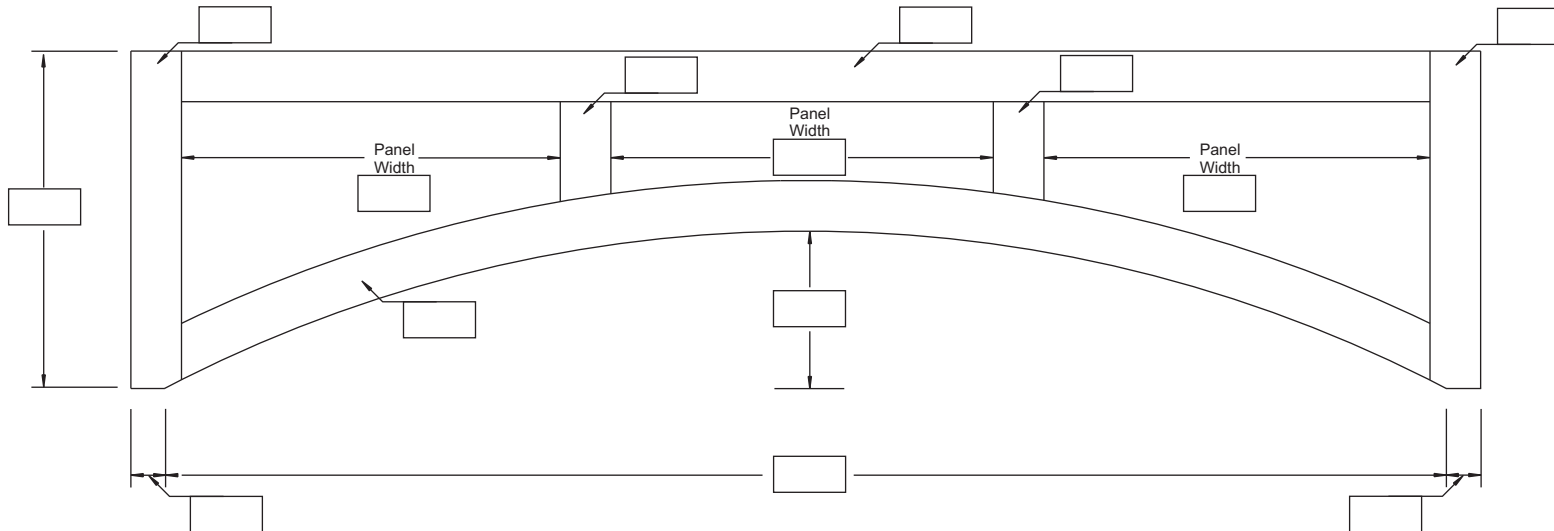

Maximum overall size: 96" W x 42" H

Panel Widths

- Equal, or
- Specified (fill in shaded area)

Due to panel expansion, recommended Panel Width with solid panels should not exceed 24".

Ordering Information

Arch Style	<input type="checkbox"/> Std Radius Arch <input type="checkbox"/> Elliptical Arch
Species	
Inside Profile <small>(See Pg. M-1.5)</small>	
Panel Profile <small>(See Pg. M-1.5)</small>	
Edge Detail <small>(See Pg. M-1.5)</small>	"E-5BB" for Square/Unsanded
Qty	
SqFt Calcs.	W _____ x H _____ /144= _____ SqFt <small>round to 1/100th SqFt</small>

Custom Frame Sizes- Price Chart

Identify the largest frame part in the configuration and enter associated multiplier into Panel Cost Calculations

Frame parts	All parts 2-1/4" Width	1.00
	From 2-3/8" to 3" Widths	1.15
	From 3-1/8" to 6" Widths	1.25
	From 6-1/8" to 12" Widths	1.35
	Over 12" Widths	1.45

Arch Panel Cost Calculations

1- Enter SqFt Pricing (from pg M-1.5)	\$
2- Custom Frame Upchg (from Chart)	1. _____
3- Adjusted SqFt Cost (Line1 x Line2)	\$
4- Total SqFt of Arch Panel	SqFt
5- Subtotal (Line3 x Line4)	\$
6- Custom Charge	\$ 390.00
7- Total Cost (Add Lines 5 & 6)	\$

Total Cost does not include Pre-finishing charges or other options.